

*jura*®



F9 – Quick Reference Guide

## F9 – Quick Reference Guide



These short instructions do not replace the 'F9 Instructions for Use'. Make sure you read and observe the safety information and warnings first in order to avoid hazards.

### Rinsing the machine

You can initiate the rinse operation manually at any time.



**Precondition:** 'Please select product' is displayed.

- ▶ Place a receptacle under the dual spout.
- P** ▶ Press the P button.  
'Maintenance status' ('1/7')
-  ▶ Turn the Rotary Switch until 'Maintenance status' ('2/7') is displayed.
- ▶ Press the 'Rinse the coffee system' button to initiate the rinse operation.  
'Machine is rinsing', water flows out of the dual spout.  
The rinse stops automatically. 'Please select product' appears on the display.

### Rinsing the milk system

After each milk preparation, the JURA F9 prompts you to perform a milk system rinsing.



**Precondition:** 'Rinse the milk system' is displayed.

- ▶ Place a receptacle under the dual spout.
-  ▶ Press the Rotary Switch.  
'Milk system is being rinsed', water flows out of the dual spout.  
The rinse stops automatically. Your JURA F9 is once more ready for use.

## Cleaning the milk system

To ensure that the milk system in the dual spout always works properly, you must clean it **daily** when you have been preparing milk.

### CAUTION

If the wrong cleaning agent is used, the machine could be damaged and/or traces could be left behind in the water.

- ▶ Use only original JURA maintenance products.

**i** JURA milk system cleaner is available from specialised dealers.

**Precondition:** 'Please select product' is displayed.

**P** ▶ Press the P button.

'Maintenance status' ('1/7')

▶ Press the 'Cappuccino cleaning' button.

▶ Press the 'Start' button.

▶ Press the 'Start' button again.

'Cleaner for Cappuccino'

▶ Remove the milk pipe from the milk container or carton.

▶ Pour 250 ml of fresh water into a receptacle and add one capful of milk system cleaner.

▶ Immerse the milk pipe in the receptacle.

▶ Place another receptacle under the dual spout.

▶ Press the 'Next' button.

'Cleaning Cappuccino', the dual spout and the pipe are cleaned.

'Water for Cappuccino'

▶ Rinse the receptacle thoroughly, fill it with 250 ml of fresh water and immerse the milk pipe in the water.

▶ Empty the other receptacle and place it under the dual spout again.

▶ Press the 'Next' button.

'Cleaning Cappuccino', the dual spout and the pipe are rinsed with fresh water.

The operation stops automatically. 'Milk system cleaning complete' appears briefly on the display.

Your JURA F9 is once more ready for use.



## Dismantling and rinsing the dual spout

The dual spout must be dismantled and rinsed **daily** if milk has been prepared to make sure it functions perfectly and also in the interests of hygiene.

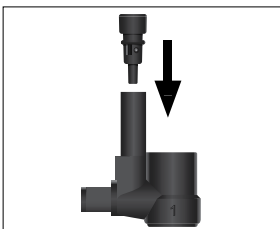
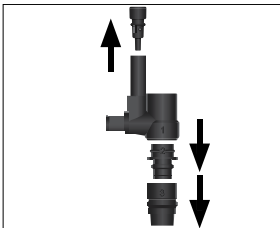
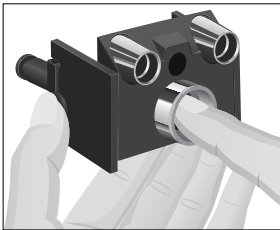
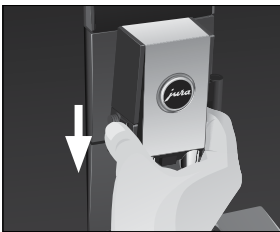
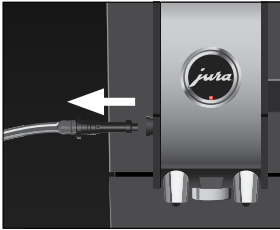

- ▶ Remove the milk pipe and rinse it thoroughly under running water.

- ▶ Press the releasing devices and pull the dual spout down and off.

- ▶ Press the milk system down and take it out.

- ▶ Dismantle the milk system into its individual parts.
- ▶ Rinse all the parts under running water. If there are severely dried-on milk residues, firstly immerse the individual parts in a solution of 250 ml cold water and 1 capful of JURA milk system cleaner. Then rinse the parts thoroughly.

- ▶ Fit the air intake pipe.

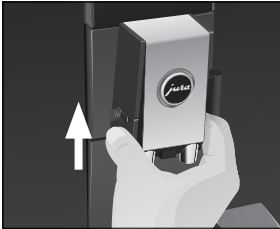
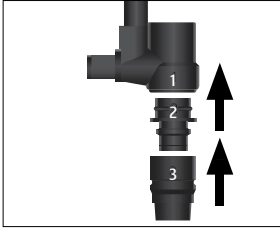

- ▶ Reassemble the milk system. When doing this, note the numbering of the individual parts.
- ▶ Fit the assembled individual parts back in the dual spout and press it firmly.
  
- ▶ Fit the dual spout on the machine. It will click into place audibly.

## Inserting and activating the filter

Your JURA F9 no longer has to be descaled if you are using the CLARIS Blue filter cartridge. If you did not activate the filter cartridge the first time you used the machine, you can do this now as follows.

- i** Perform the ‘inserting the filter’ operation without any interruptions. This will ensure that your JURA F9 always produces its best.

**Precondition:** ‘Please select product’ is displayed.

- P** ▶ Press the P button.  
‘Maintenance status’ (‘1/7’)
-  ▶ Turn the Rotary Switch until ‘Maintenance settings’ (‘6/7’) is displayed.
- ▶ Press the ‘Use filter’ button.  
‘Use filter’
- ▶ Press the ‘Active’ button.
- ▶ Press the ‘Save’ button.  
‘Saved’ appears briefly on the display.  
‘Insert filter’
- ▶ Remove and empty the water tank.



- ▶ Open the filter holder and insert the filter cartridge into the water tank, exerting slight pressure.
- ▶ Close the filter holder. It will click into place audibly.

**i** After two months, the filter will cease to work. Set the date on the date plate on the filter holder in the water tank.

- ▶ Fill the water tank with fresh, cold water and reinsert the tank.
- ▶ Press the **'Next'** button.
- ▶ **'Switch open'**



- ▶ Place a receptacle under the hot-water spout.
- ▶ Turn the switch to the **⏏** position.
- ▶ **'Filter is being rinsed'**, water flows out of the hot-water spout.

**i** You can interrupt rinsing of the filter at any time. To do this, turn the switch clockwise. Turn the switch anticlockwise to continue rinsing the filter.

**i** The water may be slightly discoloured. This is not harmful to health and does not affect the taste.

Rinsing of the filter stops automatically after approximately 300 ml. **'Switch close'** appears on the display.



- ▶ Turn the switch to the **⌚** position.
- ▶ **'Please select product'** appears on the display. The filter is now activated.

## Changing the filter

**i** After 50 litres of water have flowed through, the filter will cease to work. Your JURA F9 will automatically prompt you to change the filter.

**i** After two months, the filter will cease to work. Set the date on the date plate on the filter holder in the water tank.

**i** If the CLARIS Blue filter cartridge is not activated in programming mode, you will not be prompted to change the filter.

**i** CLARIS filter cartridges are available from specialised dealers.

**Precondition:** **'Change the filter'** is displayed.



- ▶ Press the P button.
- ▶ **'Maintenance status' (1/7)**

- ▶ Press the 'Change the filter' button.  
'Change the filter'
- ▶ Press the 'Start' button.
- ▶ Press the 'Start' button again.  
'Change filter'
- ▶ Remove and empty the water tank.
- ▶ Open the filter holder and remove the old CLARIS Blue filter cartridge.
- ▶ Insert a **new** CLARIS filter cartridge Blue into the water tank, exerting slight pressure.
- ▶ Close the filter holder. It will click into place audibly.
- ▶ Fill the water tank with fresh, cold water and reinsert the tank.



- ▶ Place a receptacle under the hot-water spout.
- ▶ Press the 'Next' button.  
'Switch open'
- ▶ Turn the switch to the  $\downarrow$  position.  
'Filter is being rinsed', water flows out of the hot-water spout.

- i** You can interrupt rinsing of the filter at any time. To do this, turn the switch clockwise. Turn the switch anticlockwise to continue rinsing the filter.
- i** The water may be slightly discoloured. This is not harmful to health and does not affect the taste.

Rinsing of the filter stops automatically after approximately 300 ml. 'Switch close' appears on the display.

- ▶ Turn the switch to the  $\odot$  position.  
'Please select product' appears on the display.

## Cleaning the machine

After 200 preparations or 80 switch-on rinses, the JURA F9 will prompt you to clean it.

### CAUTION

If the wrong cleaning agent is used, the machine could be damaged and/or traces could be left behind in the water.

- ▶ Use only original JURA maintenance products.

- i** The cleaning programme lasts approximately 20 minutes.
- i** Do not interrupt the cleaning programme. The quality of cleaning will be impaired if you do so.
- i** JURA cleaning tablets are available from specialised dealers.

**Precondition:** 'Clean machine' is displayed.

### P

- ▶ Press the P button.

'Maintenance status' ('1/7')

- ▶ Press the 'Clean' button.

'Clean'

- ▶ Press the 'Start' button.
- ▶ Press the 'Start' button again.

'Empty grounds'

- ▶ Empty the drip tray and coffee grounds container and put them back into the machine.

'Press the Rotary Switch'

- ▶ Place a receptacle under the dual spout.



- ▶ Press the Rotary Switch.

'Machine is being cleaned', water flows out of the dual spout. The operation is interrupted, 'Add cleaning tablet'.

- ▶ Open the cover of the filler funnel for ground coffee.



- ▶ Insert a JURA cleaning tablet into the filler funnel.
- ▶ Close the cover of the filler funnel.

'Press the Rotary Switch'



- ▶ Press the Rotary Switch.

'Machine is being cleaned', water flows out of the dual spout repeatedly.

The operation stops automatically.

'Empty grounds'



- ▶ Empty the drip tray and coffee grounds container and put them back into the machine.

‘Please select product’ appears on the display. Cleaning is now complete.

## Descaling the machine

The JURA F9 builds up deposits of limescale over time and automatically prompts you to descale it when necessary. The degree of calcification depends on the hardness of your water.

- i** If you use a CLARIS Blue filter cartridge and this is activated, you will not be prompted to descale.

**⚠ CAUTION** If the descaling agent comes into contact with the skin or eyes, this can cause irritation.

- ▶ Avoid contact with the skin or eyes.
- ▶ Rinse off the descaling agent with clean water. Should you get any descaling agent in your eye, see a doctor.

**CAUTION** If the wrong descaling agent is used, the machine could be damaged and/or traces could be left behind in the water.

- ▶ Use only original JURA maintenance products.

**CAUTION** If the descaling operation is interrupted, there may be damage to the machine.

- ▶ Allow the descaling programme to run to the end.

**CAUTION** If the descaling agent comes into contact with sensitive surfaces (e.g. marble), damage cannot be ruled out.

- ▶ Clean up any splashes immediately.

- i** The descaling programme lasts approximately 40 minutes.

- i** JURA descaling tablets are available from specialised dealers.

**Precondition:** ‘Decalcify machine’ is displayed.

- P** ▶ Press the P button.

‘Maintenance status’ (‘1/7’)

- ▶ Press the ‘Descal’ button.

‘Descal’

- ▶ Press the ‘Start’ button.

- ▶ Press the ‘Start’ button again.

‘Empty drip tray’

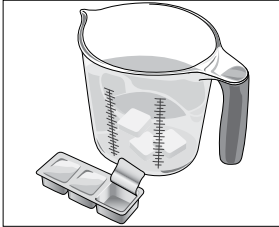

- ▶ Empty the drip tray and coffee grounds container and put them back into the machine.  
**'Agent in tank'**
- ▶ Remove and empty the water tank.
- ▶ Completely dissolve the contents of one blister (3 JURA descaling tablets) in a receptacle holding 500 ml of lukewarm water. This may take several minutes.
- ▶ Pour the solution into the empty water tank and insert it into the machine.  
**'Switch open'**
- ▶ Place a receptacle under the hot-water spout and dual spout.
- ⊖ ▶ Turn the switch to the  $\Downarrow$  position.  
**'Machine is being descaled'**, water flows out of the hot-water spout repeatedly.  
The operation is interrupted, **'Switch close'**.
- ⓘ ▶ Turn the switch to the ① position.  
**'Machine is being descaled'**, the descaling operation is continued. Water flows out of the dual spout repeatedly.  
The operation is interrupted, **'Empty drip tray'**.
- ▶ Empty the drip tray and coffee grounds container and put them back into the machine.  
**'Fill water tank.'**
- ▶ Empty the receptacle and place it under the hot water and dual spouts.
- ▶ Remove the water tank and rinse it thoroughly.
- ▶ Fill the water tank with fresh, cold water and reinsert the tank.  
**'Switch open'**
- ⊖ ▶ Turn the switch to the  $\Downarrow$  position.  
**'Machine is being descaled'**, the descaling operation is continued.  
The operation is interrupted, **'Switch close'**.
- ⓘ ▶ Turn the switch to the ① position.  
**'Machine is being descaled'**, the descaling operation is continued.  
The operation is interrupted, **'Machine is being descaled'**.  
Water flows out of the dual spout.  
**'Empty drip tray'**

- ▶ Empty the drip tray and coffee grounds container and put them back into the machine.  
‘Please select product’ appears on the display. Descaling is now complete.
- i** If the descaling operation stops unexpectedly, rinse the water tank thoroughly.